

The standard foam shooting wall is based on Danage Domino PE-foam, size 66x22x24,5 cm. Thickness 31,5 cm can also be used in PE-foam, in stead of 24,5 cm. In addition can also be used UP-foam, size 66x22x21 cm in part of or all of the shooting wall. These drawings shows standard length and size of the shooting wall. The minimum length is matching 4 pcs. 66 cm foam modules in the length. The shooting wall construction is prepared to be used with any available thickness of Danage Domino foam modules.

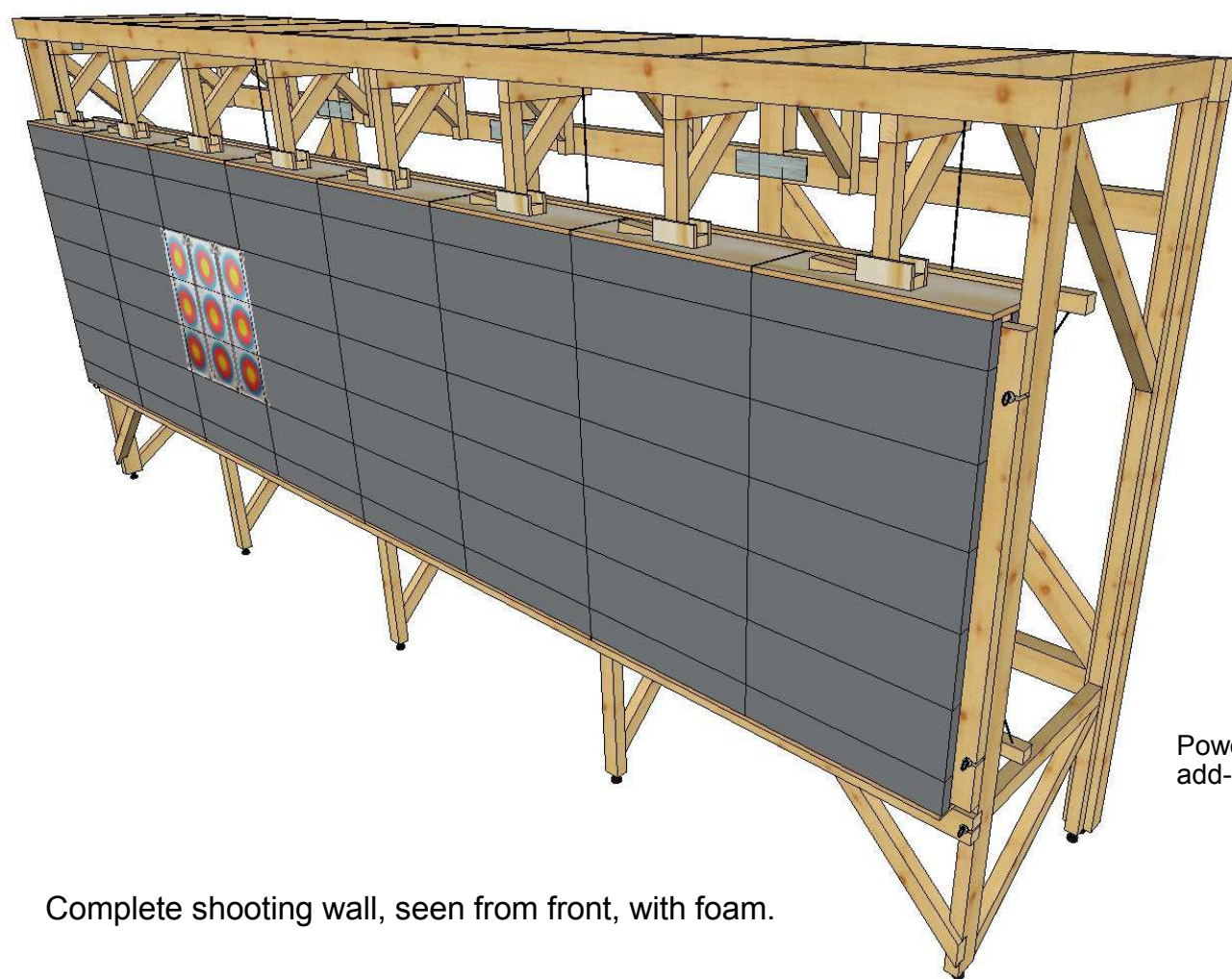

Complete shooting wall, seen from front, with foam.

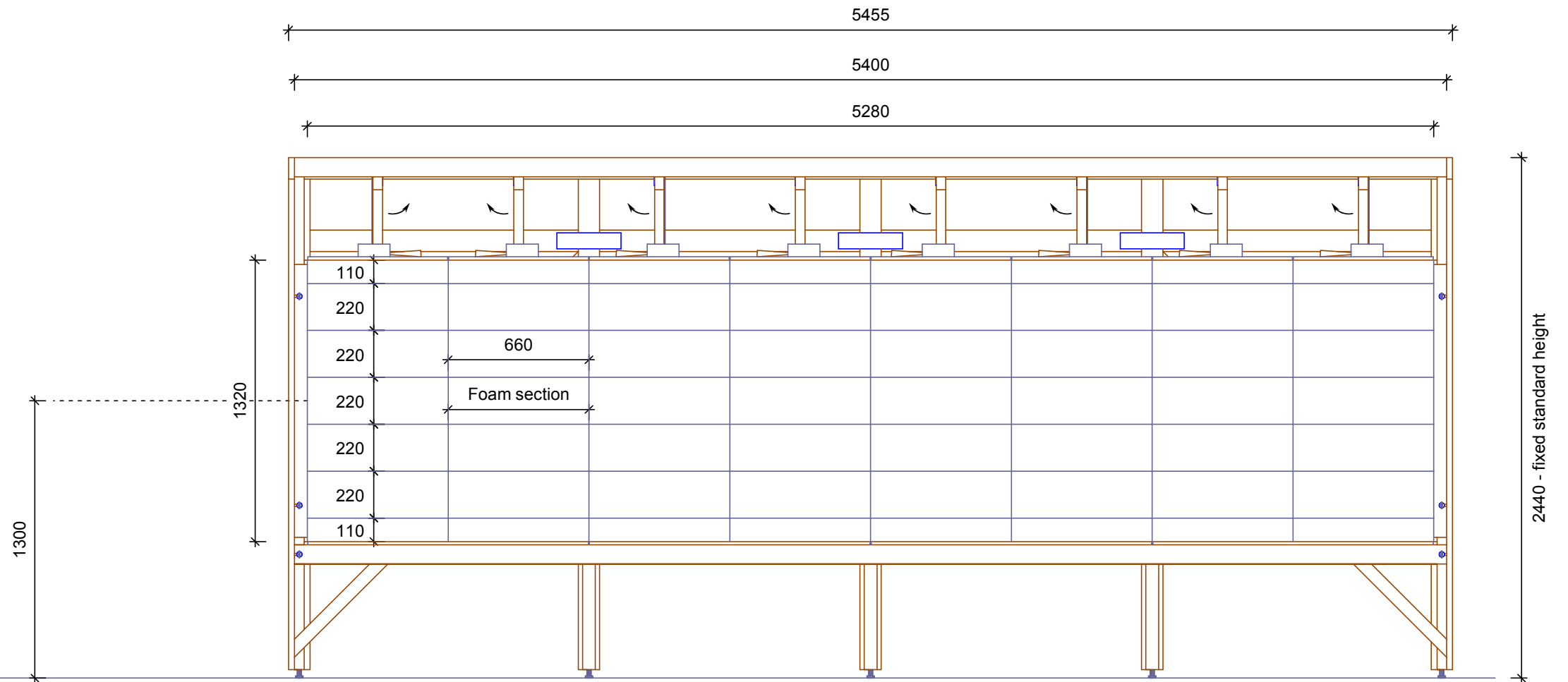
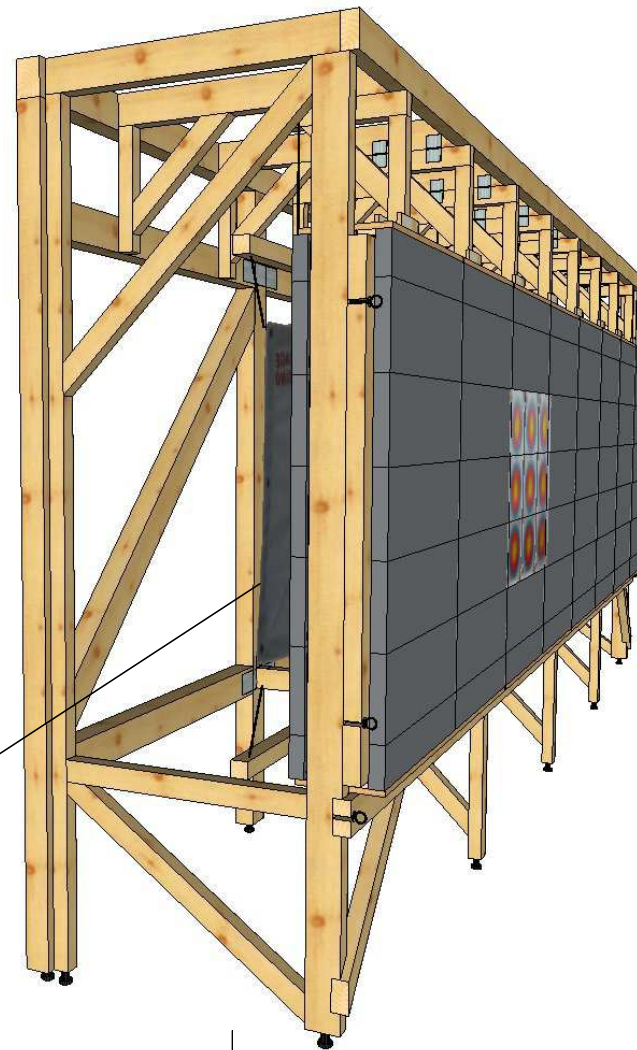

Power Stop is a add-on choice.

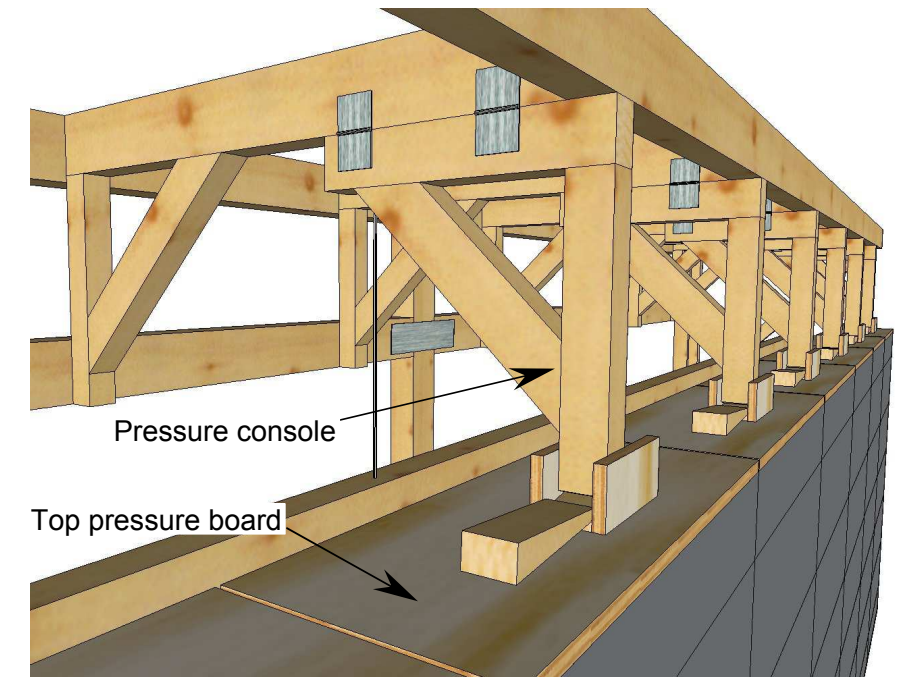

Danage Domino Standard Shooting Wall, production	Scale: 1:25	6.2	A3
Project: 15-D12 Danage Domino Shooting Wall Indoor shooting wall	Date: February 16, 2016		
	Drawing no.: 031		
DANAGE of Scandinavia ApS Industrivej 13, 6310 Broager E-mail: shop@danage.dk / danage@danage.dk Tlf.: +45 74 44 26 36 • CVR: 14362975 Hjemmeside: www.domino-target.com • © copyright all rights reserved			

In princip any size foam modules can be used in the foam wall, without changing module length of top pressure boards or bottom support boards. T.ex. 44x44 cm modules.

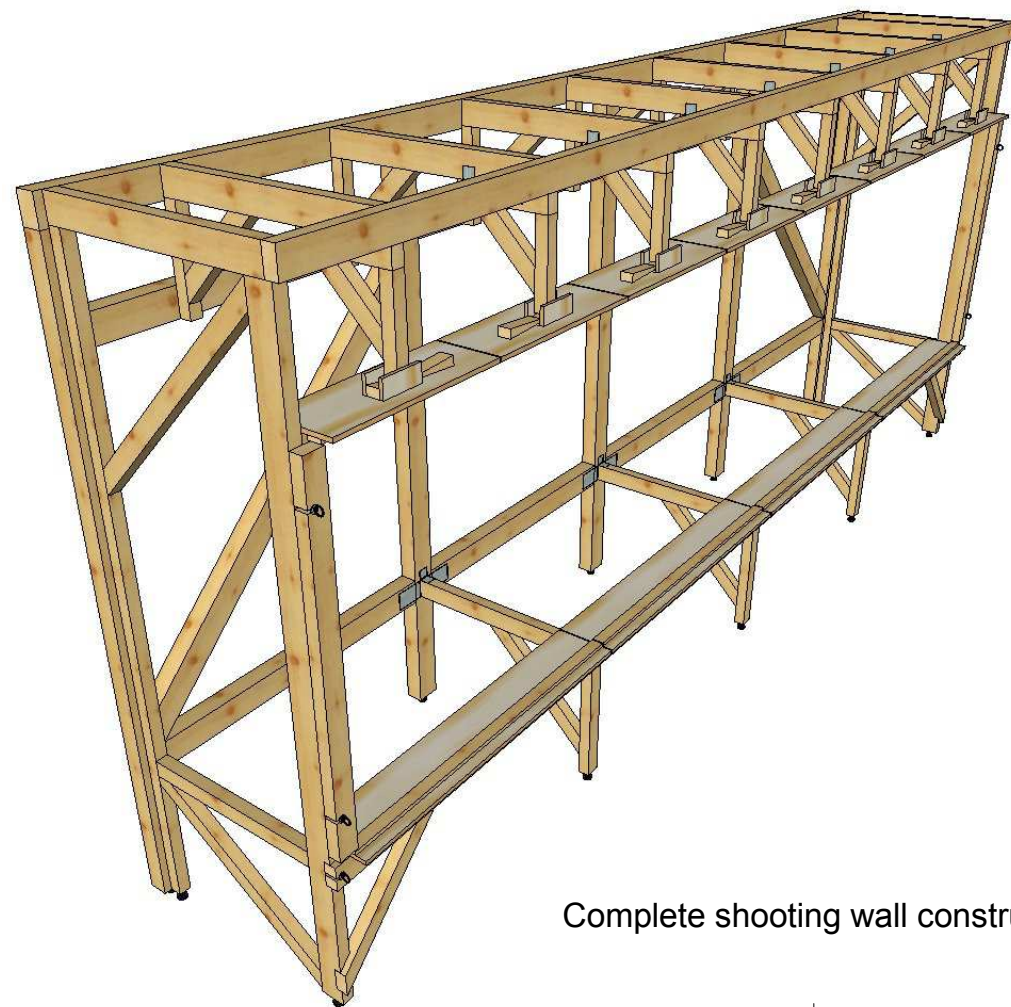
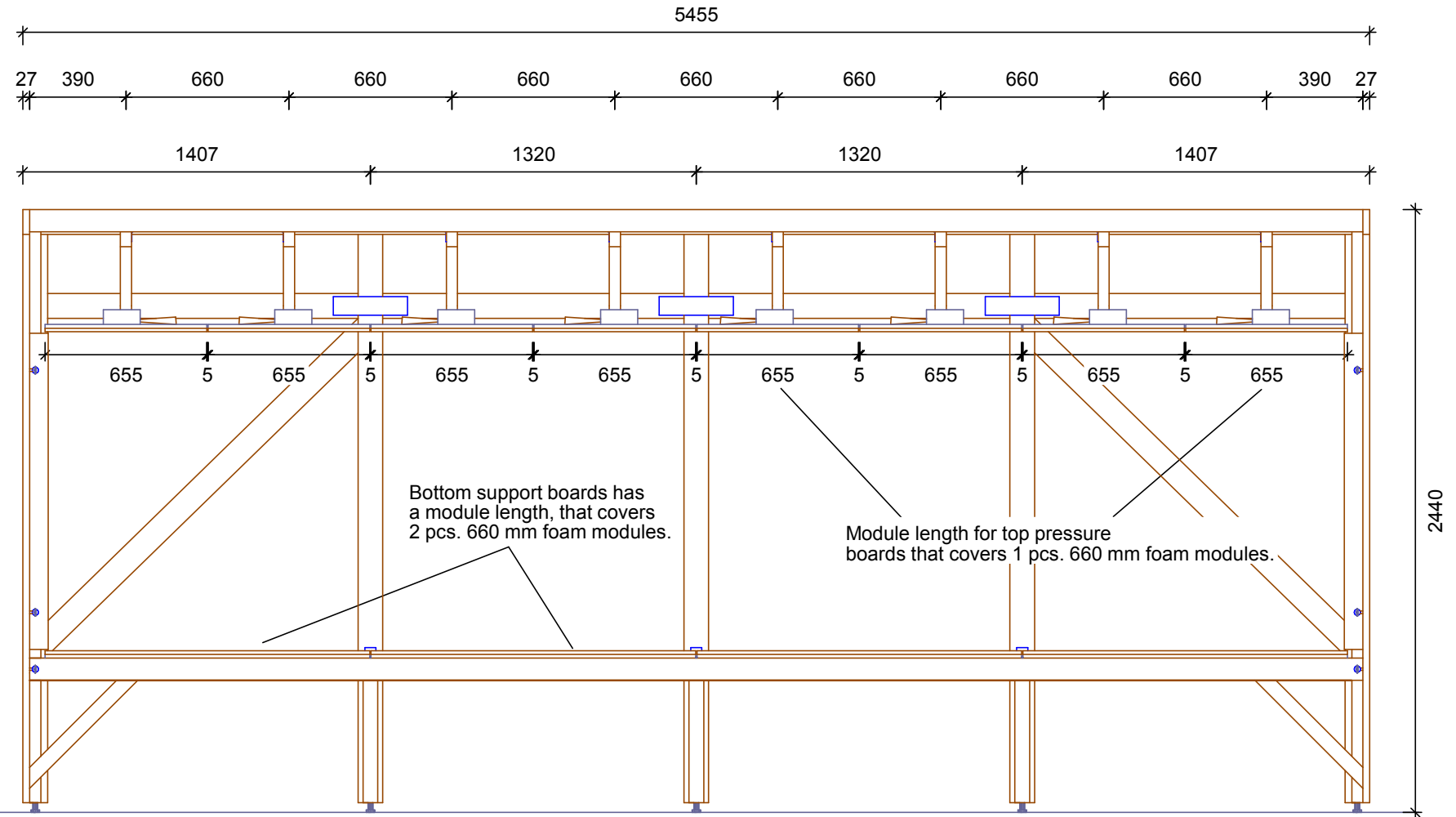

Complete shooting wall construction, seen from front, without foam.

Danage Domino Standard Shooting Wall, production	Scale: 1:25	6.2	A3
Project: 15-D12 Danage Domino Shooting Wall Indoor shooting wall	Date: February 16, 2016		
	Drawing no.: 032		
DANAGE of Scandinavia ApS Industrivej 13, 6310 Broager E-mail: shop@danage.dk / danage@danage.dk Tlf.: +45 74 44 26 36 • CVR: 14362975 Hjemmeside: www.domino-target.com • © copyright all rights reserved			

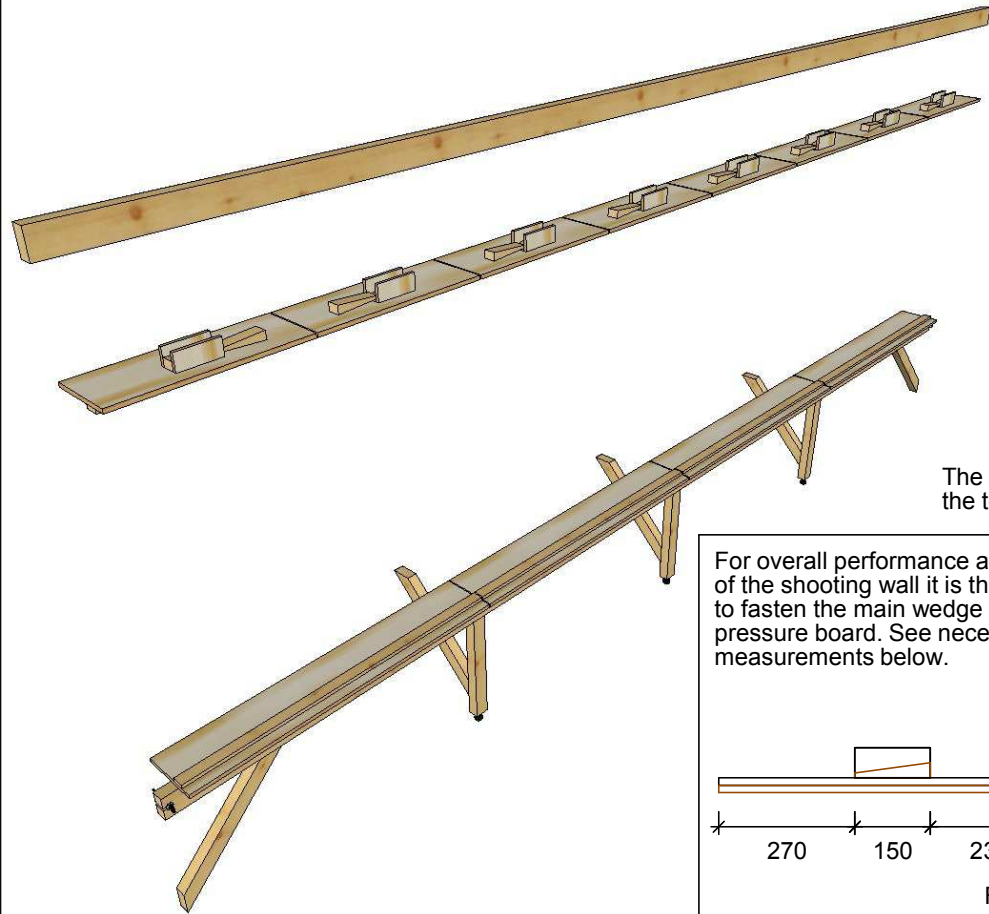

The wedges are to be fastened to the top pressure board.

For overall performance and stability of the shooting wall it is the best solution to fasten the main wedge to the top pressure board. See necessary measurements below.

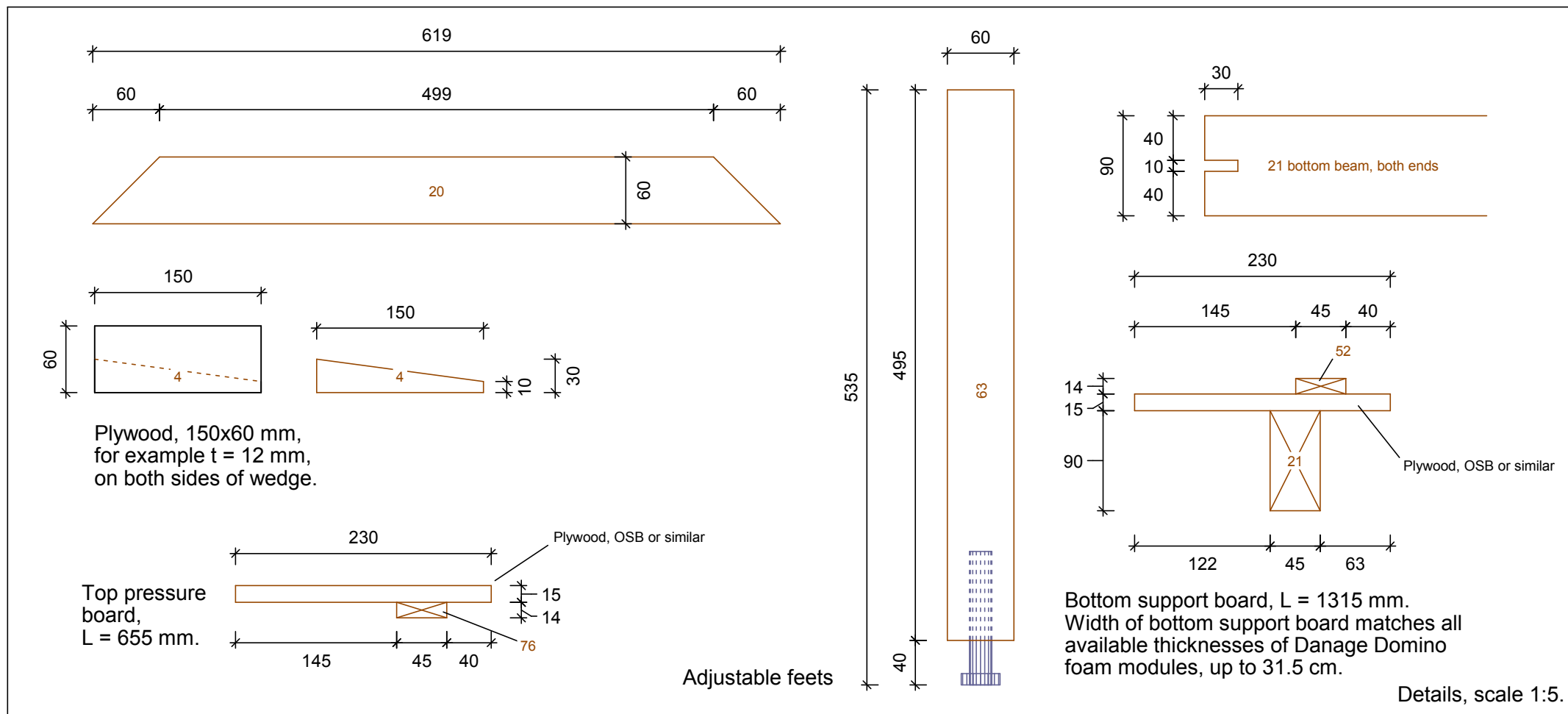
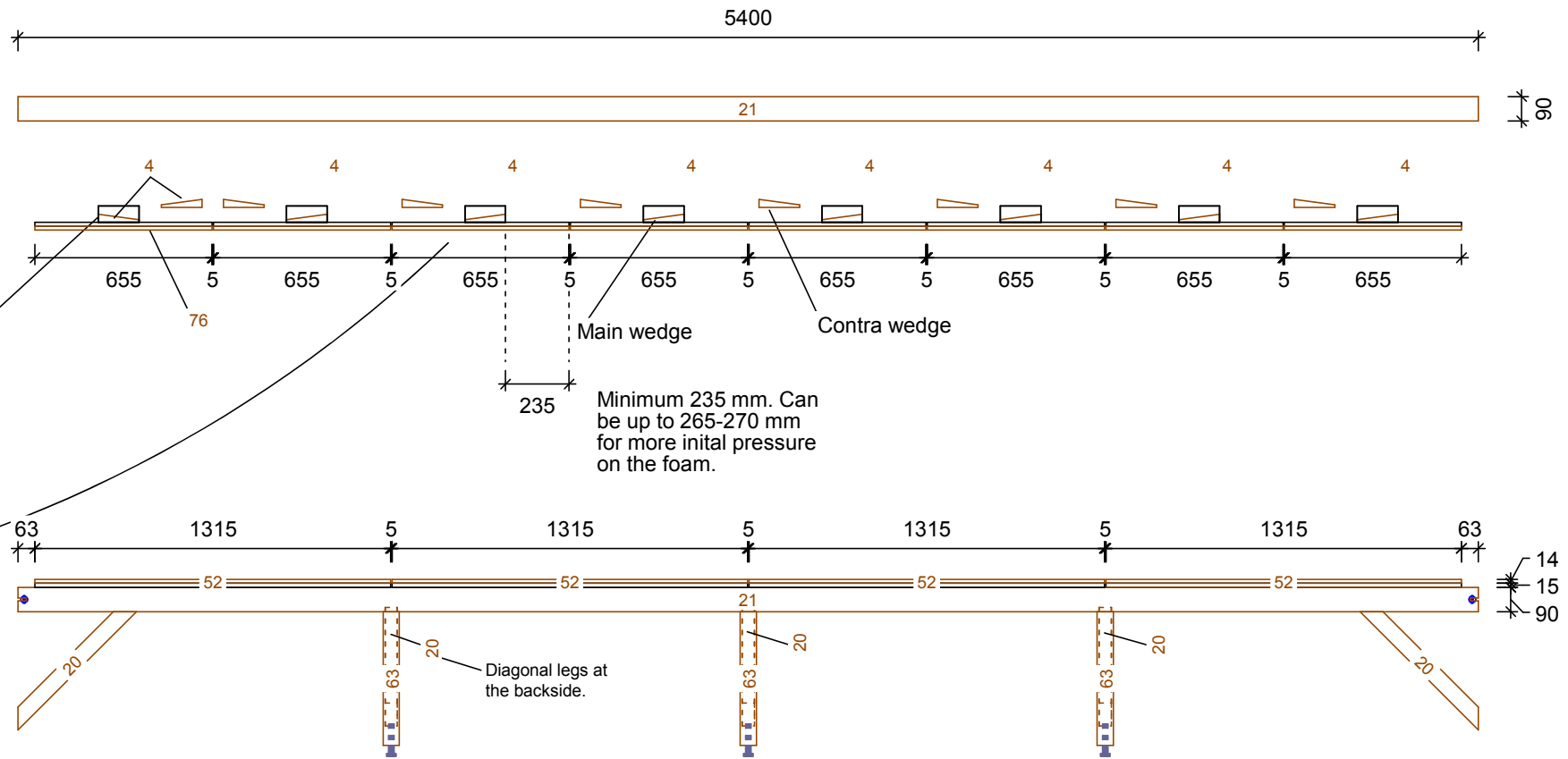
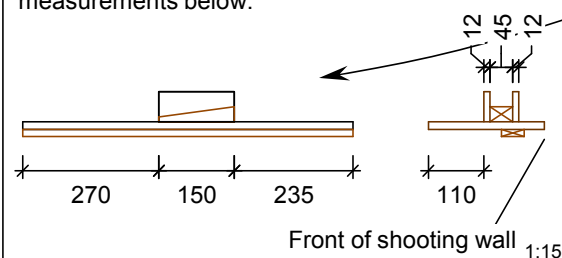

Wood:

14 x 45		
T52 :	1.315	4x
T76 :	655	8x
30 x 45		
T4 :	150	16x
60 x 45		
T20 :	619	5x
T63 :	495	3x
90 x 45		
T21 :	5.400	2x

Danage Domino Standard Shooting Wall, production	Scale: 1:25	6.2	A3
Project: 15-D12 Danage Domino Shooting Wall Indoor shooting wall	Date: February 16, 2016		
	Drawing no.: 033		

DANAGE of Scandinavia ApS
 Industrivej 13, 6310 Broager
 E-mail: shop@danage.dk / danage@danage.dk
 Tlf.: +45 74 44 26 36 • CVR: 14362975
 Hjemmeside: www.domino-target.com • © copyright all rights reserved

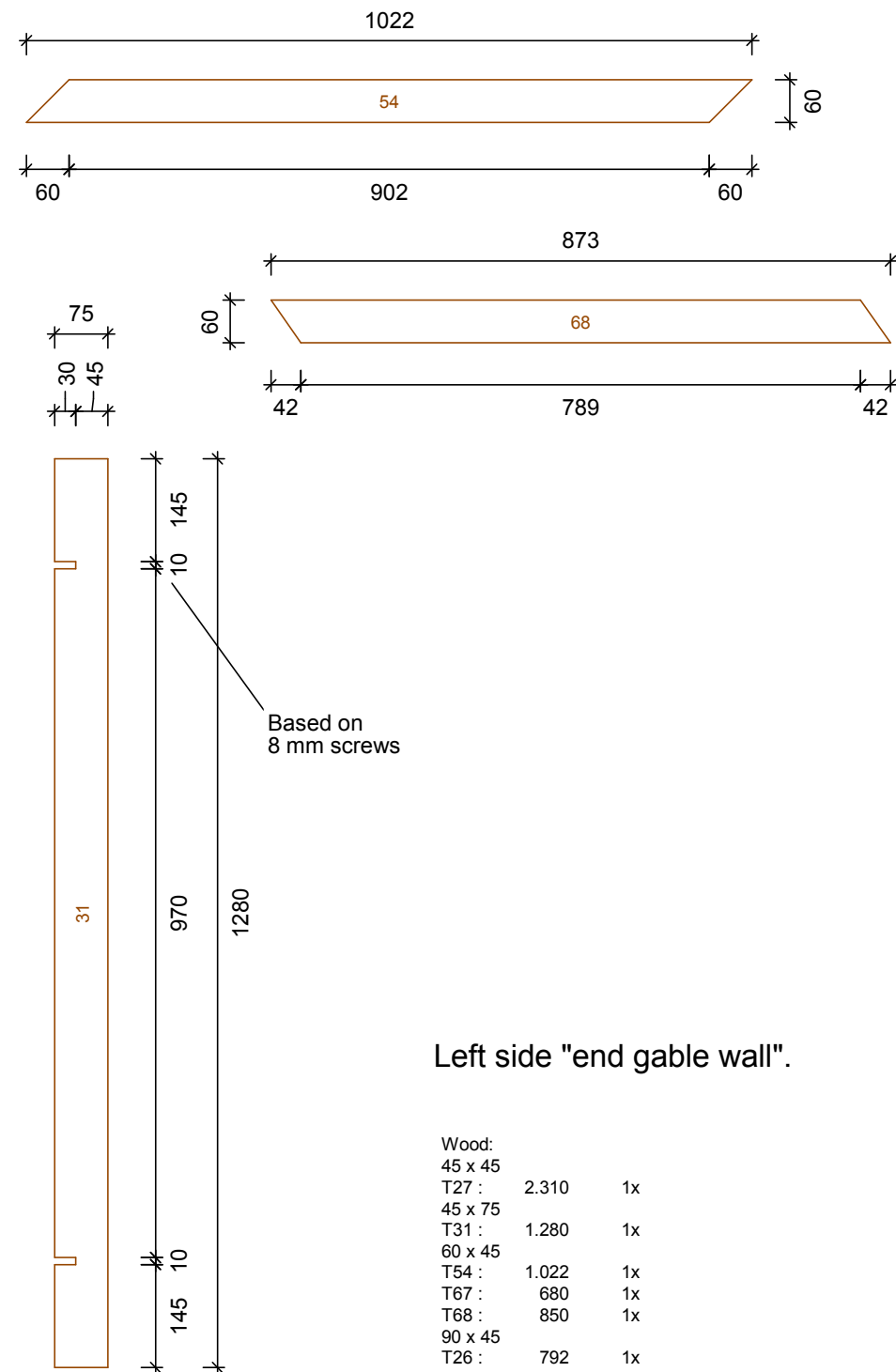
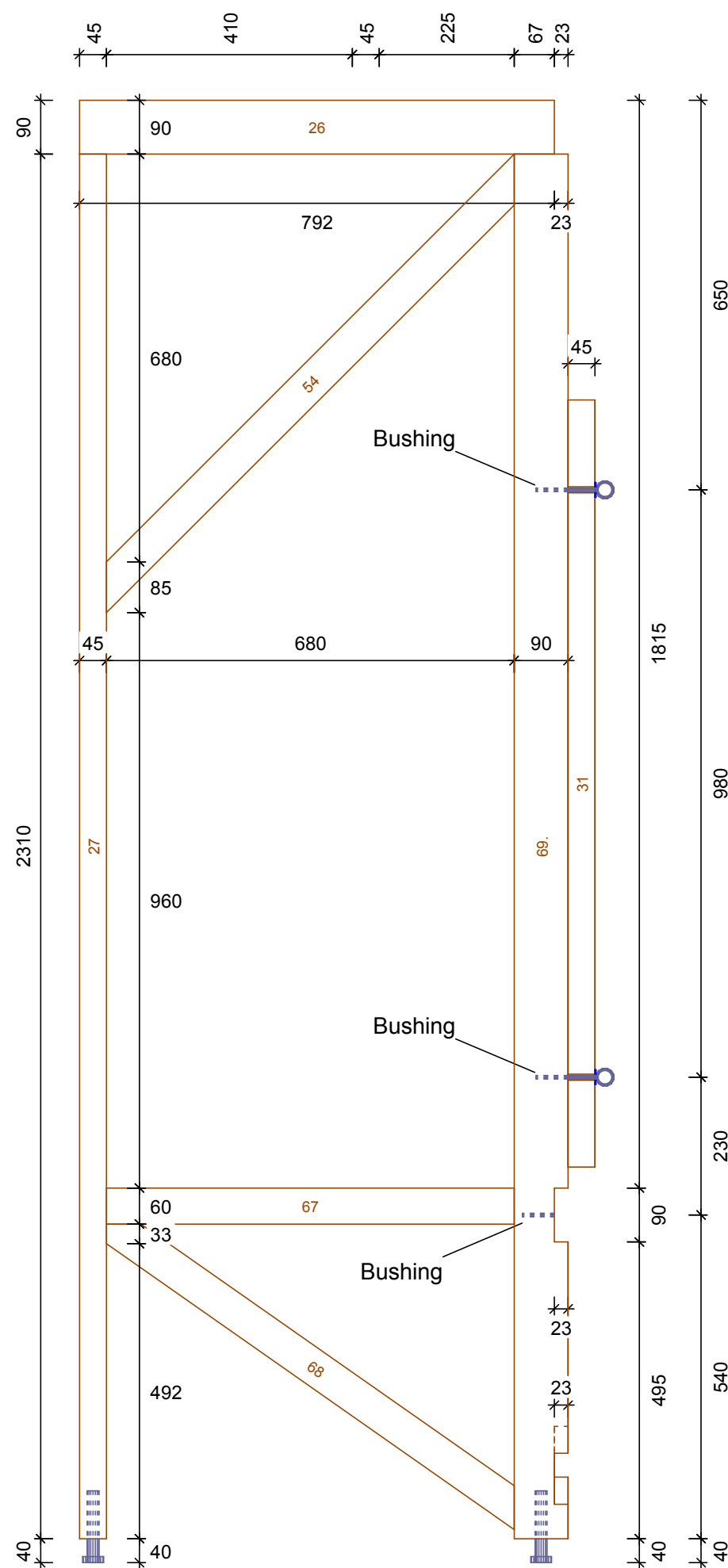

Left side "end gable wall".

Wood:

45 x 45		
T27 :	2.310	1x
45 x 75		
T31 :	1.280	1x
60 x 45		
T54 :	1.022	1x
T67 :	680	1x
T68 :	850	1x
90 x 45		
T26 :	792	1x
T69 :	2.310	1x

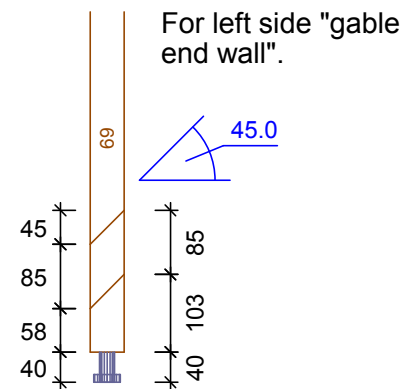

For left side "gable end wall".

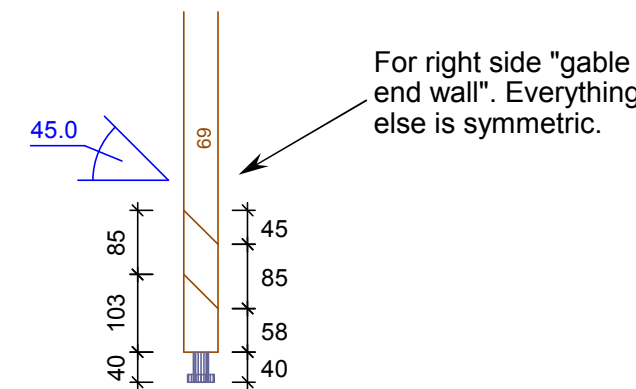

For right side "gable end wall". Everything else is symmetric.

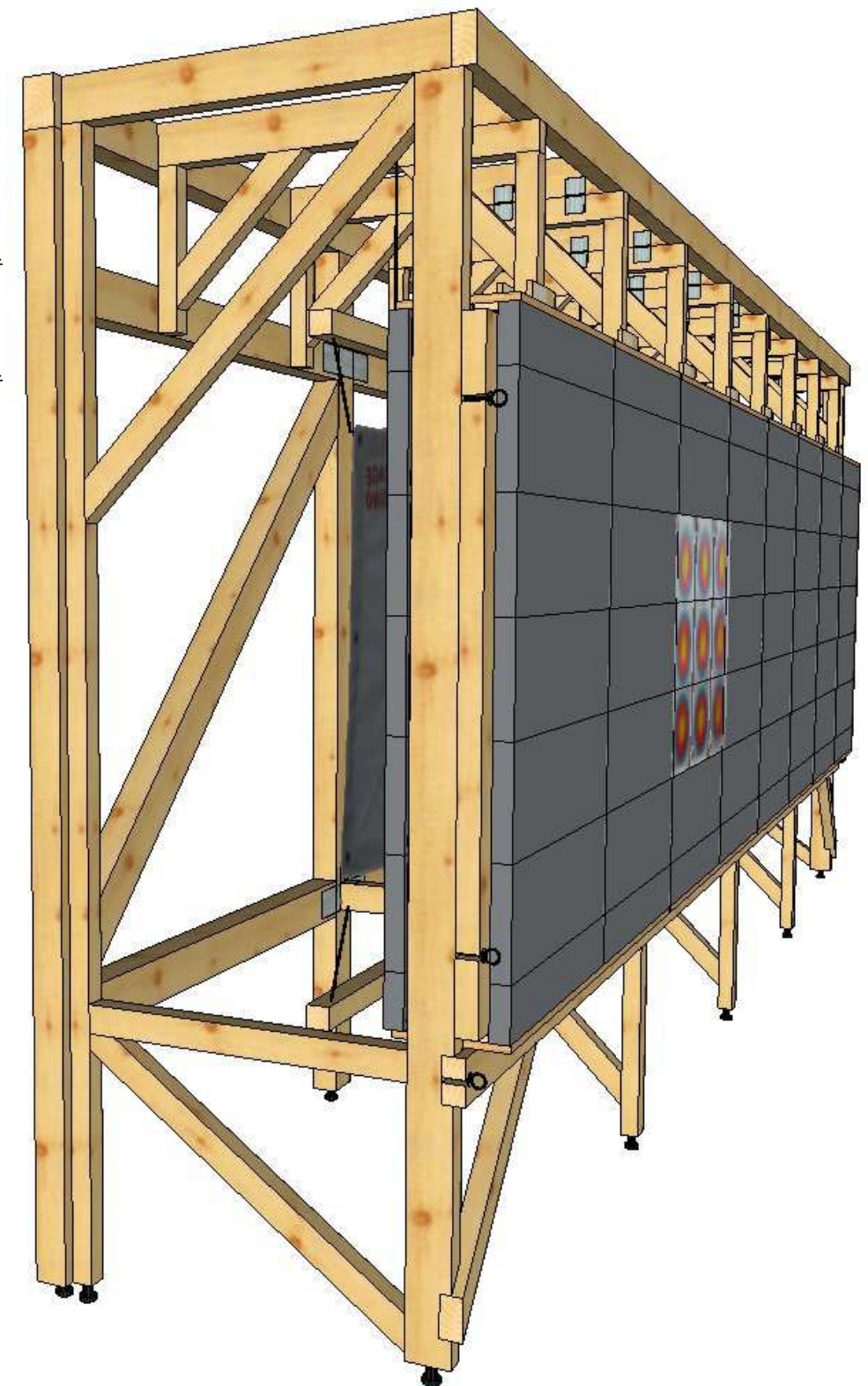

Danage Domino Standard Shooting Wall, production	Scale: 1:10	6.2	A3
Project: 15-D12 Danage Domino Shooting Wall Indoor shooting wall		Date: February 16, 2016	
		Drawing no.: 034	
DANAGE of Scandinavia ApS Industrivej 13, 6310 Broager E-mail: shop@danage.dk / danage@danage.dk Tlf.: +45 74 44 26 36 • CVR: 14362975 Hjemmeside: www.domino-target.com • © copyright all rights reserved			

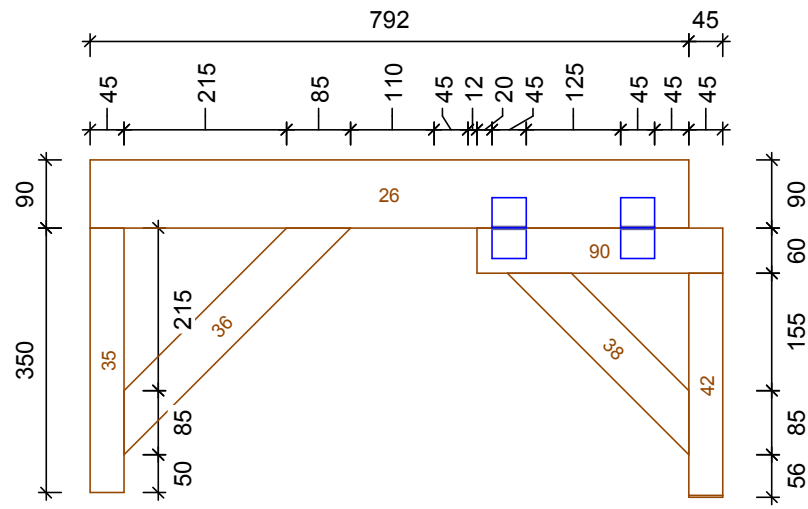

Pressure console part.
8 pressure console parts
for 1/1 standard size
Danage Domino Standard
Shooting Wall.

- Wood:
- 45 x 45
 - T35 : 350 1x
 - T42 : 296 1x
 - 60 x 45
 - T36 : 424 1x
 - T38 : 339 1x
 - T90 : 325 1x
 - 90 x 45
 - T26 : 792 1x

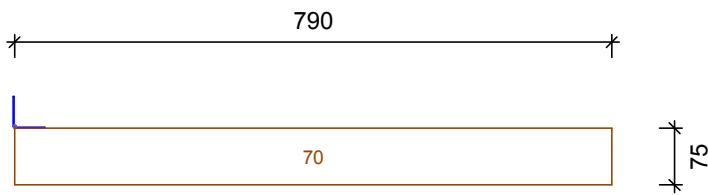
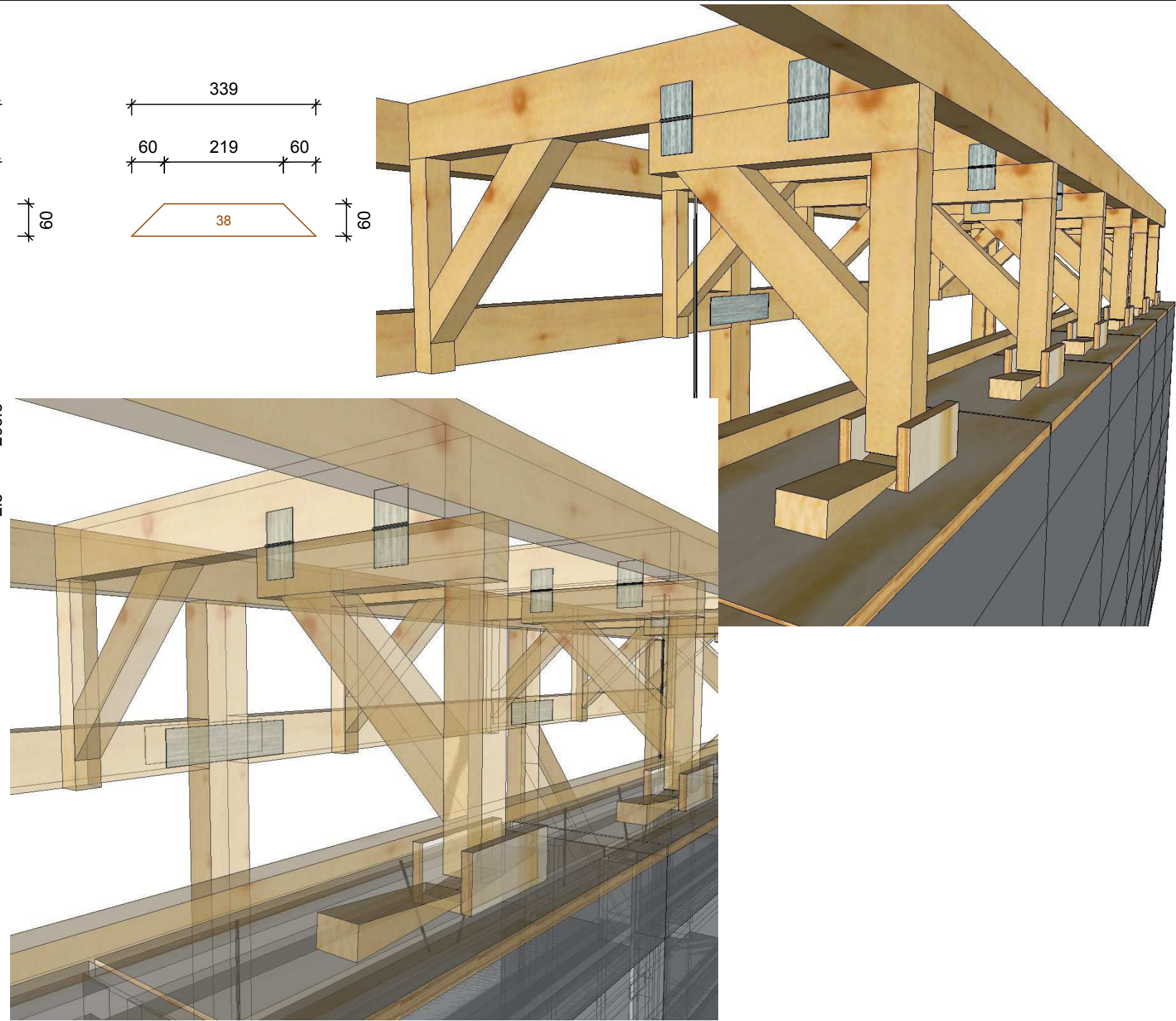
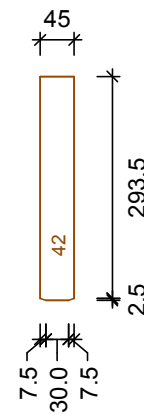
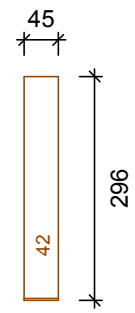
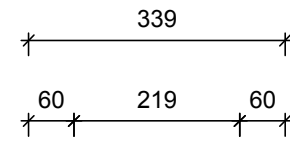
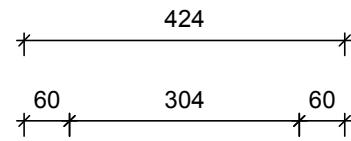

Cross sectional support beam.
3 cross sectional support beams
for 1/1 standard size
Danage Domino Standard
Shooting Wall.

- Wood:
- 75 x 45
 - T70 : 790 1x

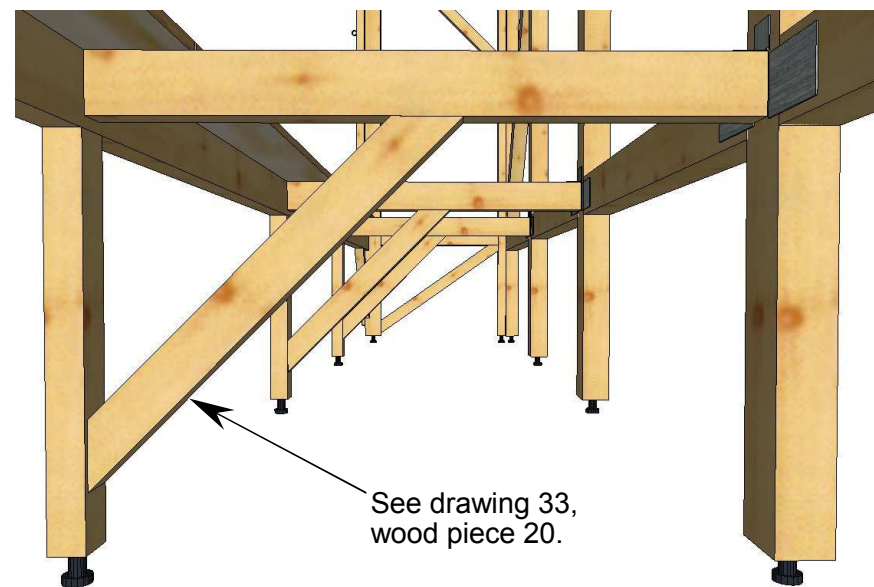

See drawing 33,
wood piece 20.

Standard details throughout the shooting wall.

Danage Domino Standard Shooting Wall, production	Scale: 1:10	6.2	A3
Project: 15-D12 Danage Domino Shooting Wall Indoor shooting wall	Date: February 16, 2016		
			Drawing no.: 035

DANAGE of Scandinavia ApS
Industrivej 13, 6310 Broager
E-mail: shop@danage.dk / danage@danage.dk
Tlf.: +45 74 44 26 36 • CVR: 14362975
Hjemmeside: www.domino-target.com • © copyright all rights reserved

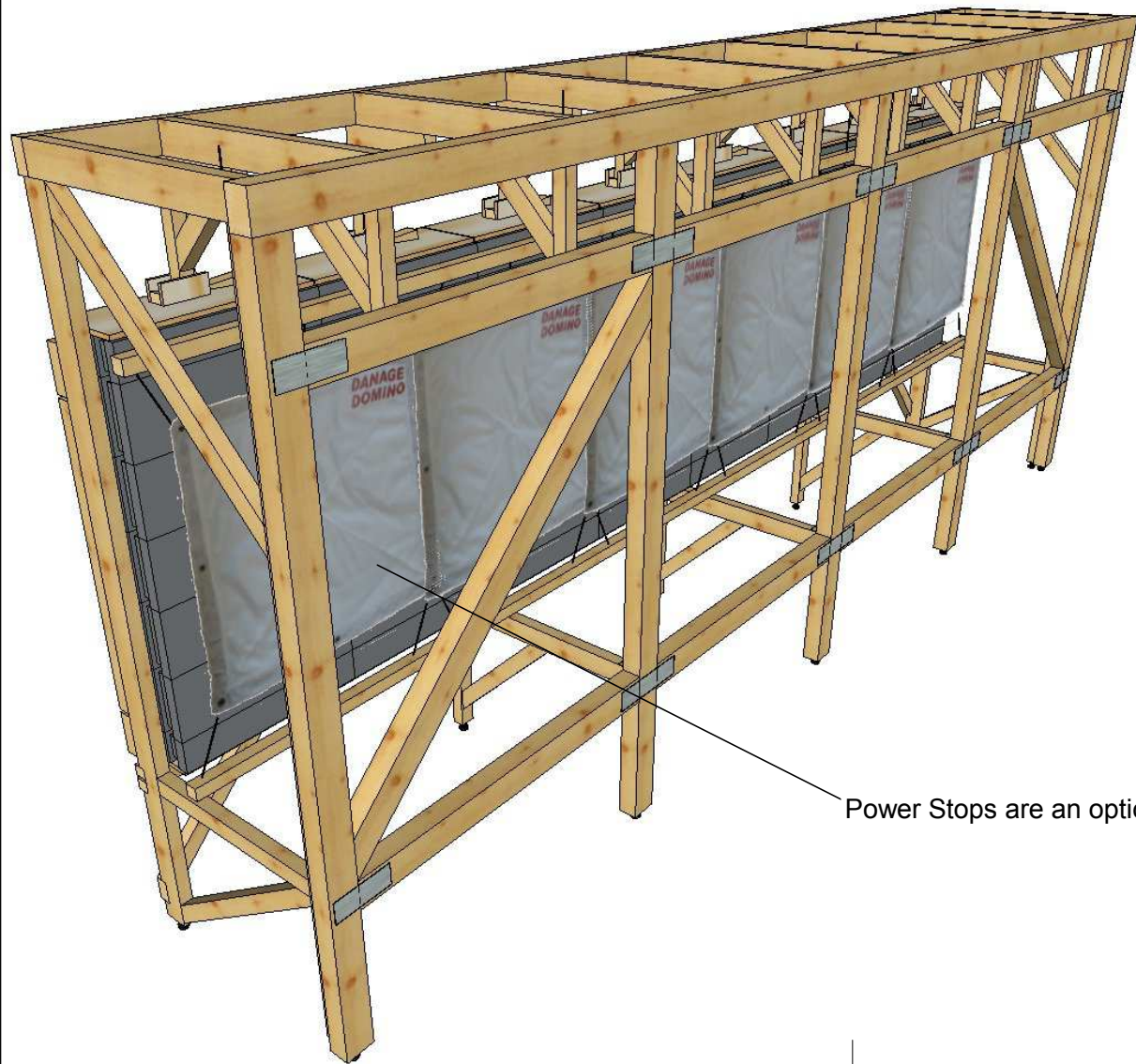
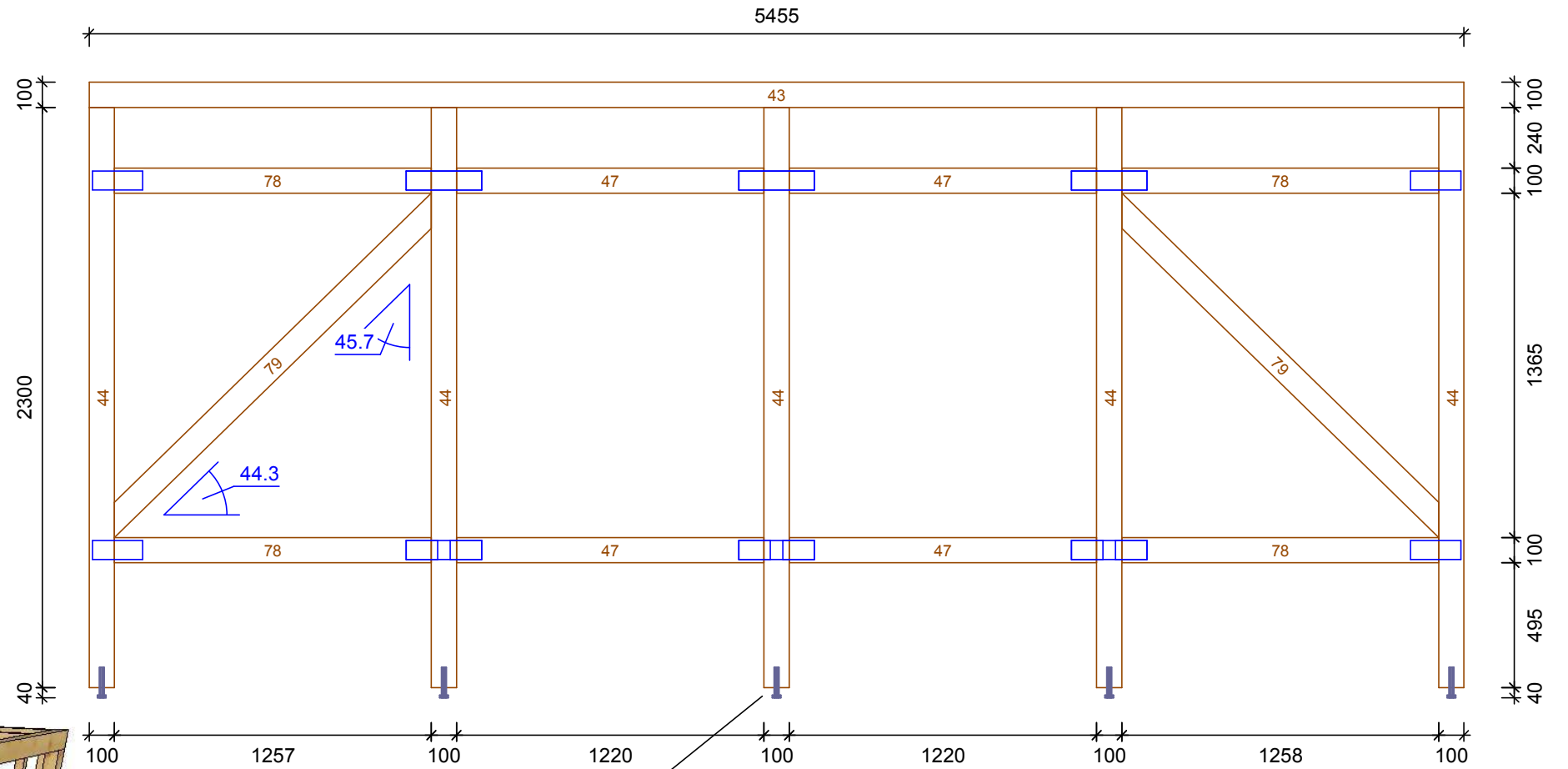
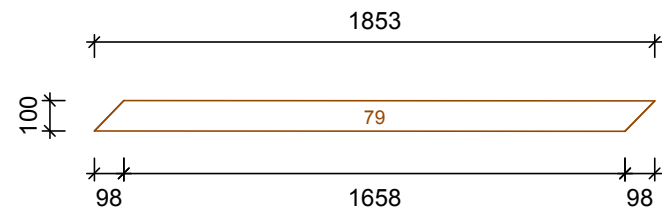

Power Stops are an optional choice.

The Danage Domino Standard Shooting Wall, is with adjustable legs, to make it easier to put the shooting wall up, in level with horizontal, even at un-even floors. In stead of adjustable legs, one can also choose to let the legs go down to the floor except 3 mm and add rubber at the bottom of the legs. For example if one wants to bolt the construction to the floor.

Back wall construction.

Wood		
100 x 70		
T43 :	5.455	1x
T44 :	2.300	5x
T47 :	1.220	4x
T78 :	1.258	4x
T79 :	1.853	2x

The back wall construction can be opted out, if it is possible to use an existing wall as back wall for the Shooting Wall.

Danage Domino Standard Shooting Wall, production	Scale: 1:25	6.2	A3
Project: 15-D12 Danage Domino Shooting Wall Indoor shooting wall	Date: February 16, 2016		
Drawing no.: 036			
DANAGE of Scandinavia ApS Industrivej 13, 6310 Broager E-mail: shop@danage.dk / danage@danage.dk Tlf.: +45 74 44 26 36 • CVR: 14362975 Hjemmeside: www.domino-target.com • © copyright all rights reserved			

The hook is hanging in the top eye-screw, ready to receive the pressure console in case of maintenance on the shooting wall foam.
 The hook can be hanging directly in the eye-screw, in a key-ring or a rubber band. But "directly" should work in most cases.

Appr. 50 mm, but not less

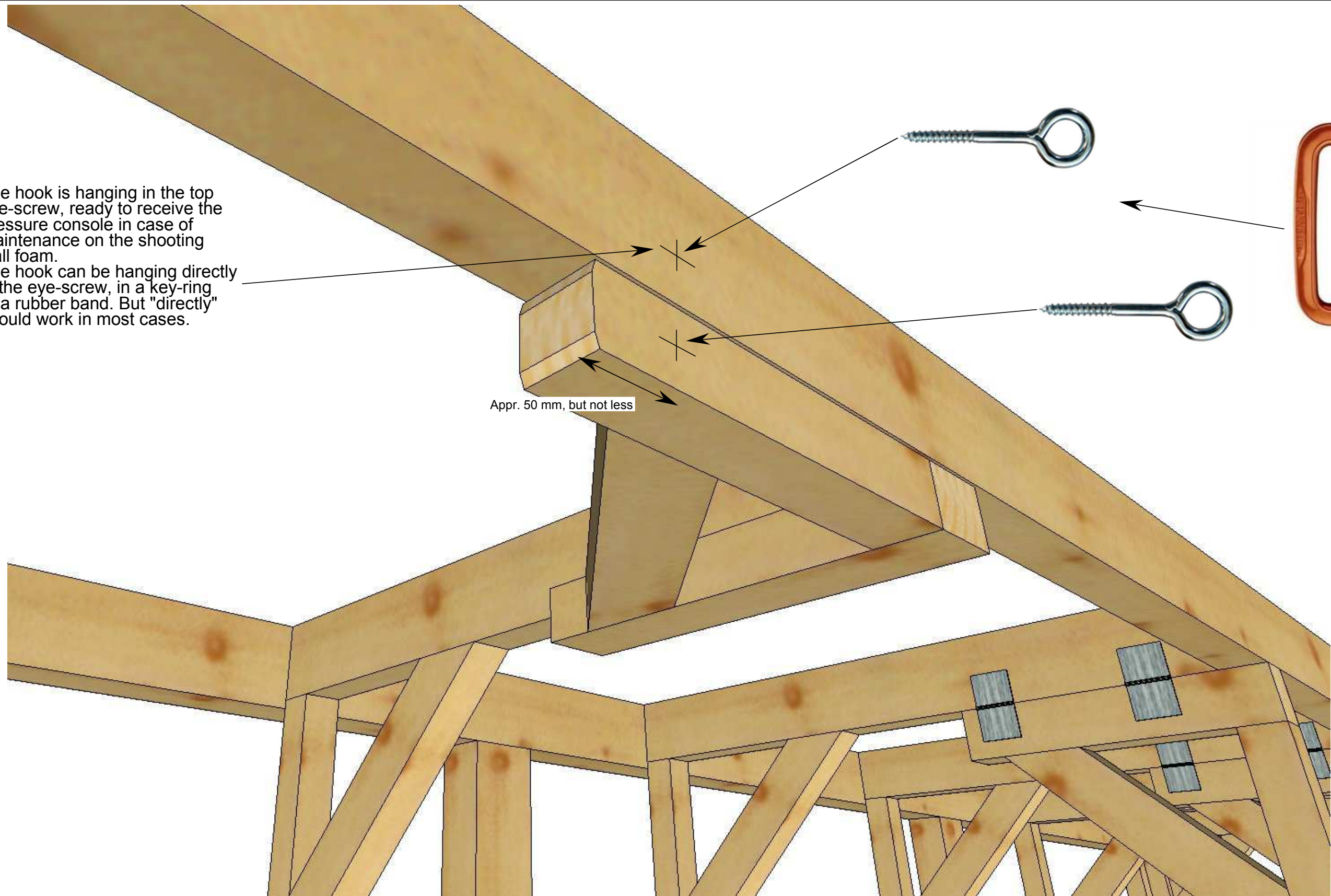

Danage Domino Standard Shooting Wall, production	Scale:	6.2	A3
Project: 15-D12 Danage Domino Shooting Wall Indoor shooting wall	Date: February 16, 2016		
	Drawing no.: 037		
DANAGE of Scandinavia ApS Industrivej 13, 6310 Broager E-mail: shop@danage.dk / danage@danage.dk Tlf.: +45 74 44 26 36 • CVR: 14362975 Hjemmeside: www.domino-target.com • © copyright all rights reserved			

Princip sketches of mounting PowerStops behind shooting wall.

Here the Power Stop beam is mounted hanging in the shooting wall construction, like shown with a chain, a carabiner and a eyebolt. The eyebolt is mounted through the beam, and fastened with a nut. With the chain the height can be roughly adjusted, and then with the eyebolt / nut, the height can be "fine tuned". Mount the eyebolts with a convenient cc distance - could be for every 3rd or 4th pressure console assembly, i.e. appr. cc 1200 to 1980 mm. If you look at the Shooting wall from the front, the chains are fastened (from left) at the 1st, the 3th, the 6th and the last pressure console.

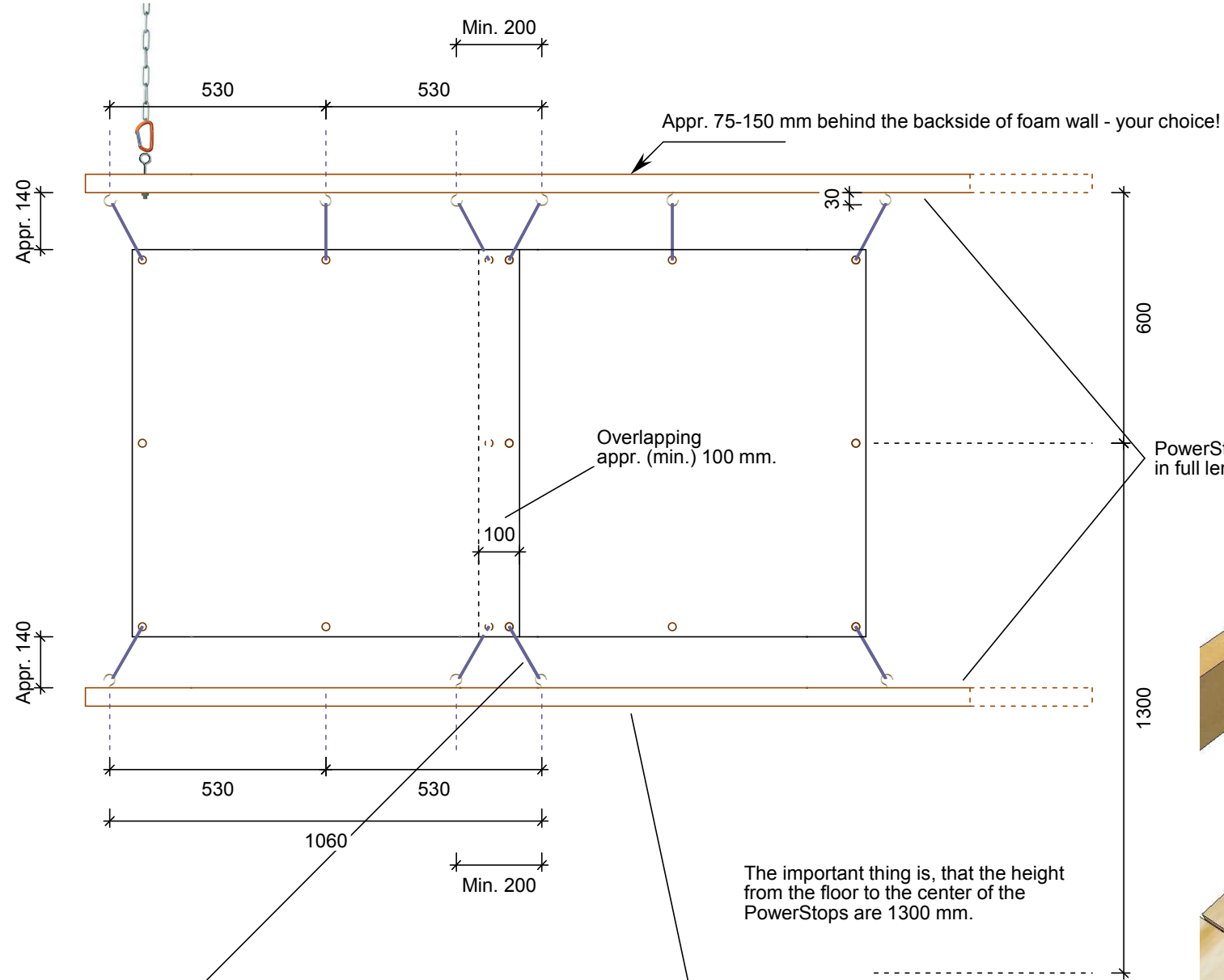

PowerStop beams in full length of shooting wall.



The important thing is, that the height from the floor to the center of the PowerStops are 1300 mm.

The bottom Power Stop beam, should always be above the support beams, so the Power Stop is hanging free.



The PowerStop cords; Made from rubber band like Shock Cord, banded in one end with a knot. The loop end of the cord goes through the holes in the PowerStop and the knot holds the cord. Length of rubber band, before making the knot, appr. 350 mm. Finished length of the cords appr. 140 mm.

Note that the chains must be fastened to the opposite side of the hinges of the pressure consoles. I.e. to the opposite side of what way the pressure consoles swings.

Danage Domino Shooting Wall, PowerStops	Scale: 1:15	6.2	A3
Project: 15-D12 Danage Domino Shooting Wall Indoor shooting wall	Date: February 16, 2016		
	Drawing no.: 038		